

Femelle DIN
Female DIN

(DIN 11851)

DN	DN connexion	Dimensions (mm)			Filetages /Threads	Ecrrous /Nuts	
		L	C	D			
3/8"	10	DIN 10	42,0	17,0	38,0	Rd 28x1/8"	754 44 02
1/2"	13	DIN 15	46,0	18,0	44,0	Rd 34x1/8"	754 44 04
3/4"	20	DIN 20	56,0	21,0	54,0	Rd 44x1/6"	754 44 06
1"	25	DIN 25	58,5	22,0	63,0	Rd 52x1/6"	754 44 08
1"1/4	32	DIN 32	58,5	22,0	70,0	Rd 58x1/6"	754 44 10
1"1/2	38	DIN 40	60,0	22,0	78,0	Rd 65x1/6"	754 44 12
2"	50	DIN 50	69,0	24,0	92,0	Rd 78x1/6"	754 44 14
2"1/2	63	DIN 65	88,0	32,0	112,0	Rd 95x1/6"	754 44 16
3"	76	DIN 80	88,0	32,0	127,0	Rd110x1/4"	754 44 18
4"	100	DIN 100	100,0	44,0	148,0	Rd130x1/4"	754 44 20

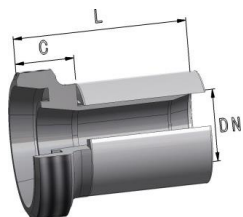

Mâle DIN
Male DIN

(DIN 11851)

(*) **matière / material**

E EPDM
N NITRILE
S SILICONE
V FKM
T PTFE

DN	DN connexion	Dimensions (mm)		Filetages /Threads	Ecrrous /Nuts	
		L	C			
3/8"	10	DIN 10	40,5	15,5	Rd 28x1/8"	756 6702 (*)
1/2"	13	DIN 15	44,0	16,0	Rd 34x1/8"	756 6704 (*)
3/4"	20	DIN 20	54,0	19,0	Rd 44x1/6"	756 6706 (*)
1"	25	DIN 25	55,5	19,0	Rd 52x1/6"	756 6708 (*)
1"1/4	32	DIN 32	57,5	21,0	Rd 58x1/6"	756 6710 (*)
1"1/2	38	DIN 40	58,0	20,0	Rd 65x1/6"	756 6712 (*)
2"	50	DIN 50	66,0	21,0	Rd 78x1/6"	756 6714 (*)
2"1/2	63	DIN 65	79,0	23,0	Rd 95x1/6"	756 6716 (*)
3"	76	DIN 80	82,5	26,5	Rd110x1/4"	756 6718 (*)
4"	100	DIN 100	82,5	26,5	Rd130x1/4"	756 6720 (*)

(C) : Références avec embout rallongé pour montage coquille, dimension L différente
Reference with longer nipples for reusable ferrules assembly, L dimension differs

La forme et la dimension des pièces sont données à titre indicatif, elles peuvent être modifiées sans préavis.
The shape and the dimensions of the items are purely indicative, they can change without notice.